

# LEXiNG<sup>®</sup>

## LX-LD-WL6 Sensor Night Lamp Instruction

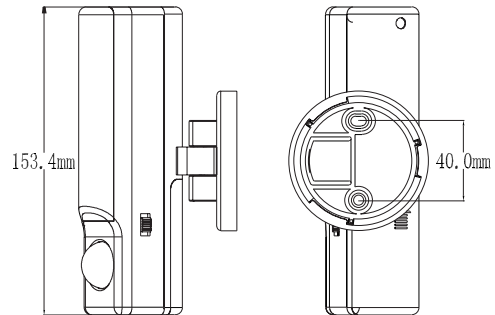
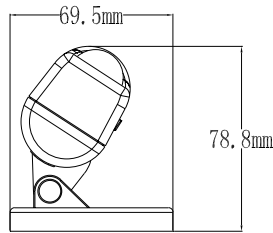

### Summary

The LX-LD-WL6 is a new type of energy saving motion sensor lamp; the light become brighter and service time longer, it adopts PIR technology to sense motion and turn on the light automatically; it is an automatic lamp which will be on when one comes and automatically off after leaves. If you want the light to remain on for an extended period of time, just slide the switch to the "ON" setting to turn the light on and keep it on, until you turn the switch off.

### Operation

- >Insert 4X1.5VAA batteries into the battery box;
  - >Slide the switch to "ON", the lamp is always on, here no sense function;
  - >Slide the switch to "OFF", the lamp is powered off;
  - >When the light of the environment is at less than 10 LUX, Slide the switch to "AUTO", the sensor is activated. The lamp will turn on when motion is detected. The lamp will automatically turn off 10±2s later after the last motion is detected;
  - >Low-voltage Alarm: When the battery power is shortage, after the Products detect mobile signal. The red LED will flicker every 5sec until the user replace batteries;
  - >Time delay is added continually: When it receives the second induction signals after the first induction, it will compute time once more on the rest of the first time-delay basis (set time).
- (Please see diagram.1)

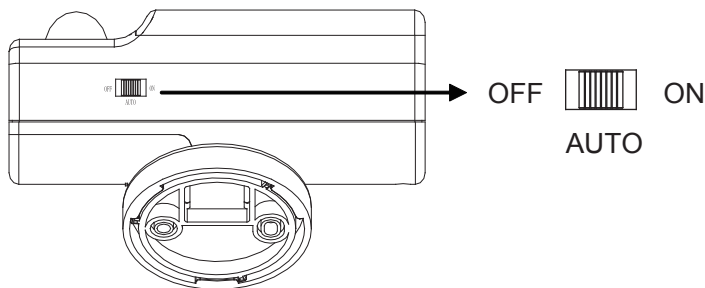

fig.1

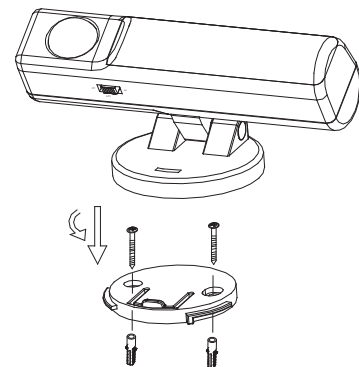

fig.2

Installation figure(Please see fig.2)

## Attentions

- (1) The product shouldn't be used in the zones the air temperature changes obviously: for example air conditioning and air heating;
- (2) In front of the detection window there should be no obstruction or moving object to effect its detecting.

## Problems and solutions

### ① the sensor sensitivity is low

- Please check if in front of the detection window there is obstruction effecting the sensor to receive signal;
- Please check if the temperature is too high;
- Please check if the sense signal is in the detection range;

### ② the sensor can not shut off the lamp automatically

- Check if in the detection range there is continual sense signal;
- If the battery accords with instruction required;
- If the air temperature near the sensor lamp change obviously, for example air conditioning or air heating, etc.



## Warning!

- Please confirm with professional installation.
- Please cut off power supply before installation and removal operations.
- Make sure that you have cut off the power for safety purposes.
- Improper operation caused losses, the manufacturer does not undertake any responsibility.

We are committed to promoting the product quality and reliability, however, all the electronic components have certain probabilities to become ineffective, which will cause some troubles. When designing, we have paid attention to redundant designs and adopted safety quota to avoid any troubles.

This instruction, without our permission, should not be copied for any other purposes.

## NINGBO LEXING INDUCTOR ELECTRONIC CO., LTD

Add: No. 35 Zhuquan Road, Science & Technology Area.  
Ninghai, Ningbo, Zhejiang, China  
Tel: +86-574-65335088  
Fax: +86-574-65335000 65335333

E-mail: [lexing@lexing.com.cn](mailto:lexing@lexing.com.cn)  
E-mail: [lexing@globalmarket.com](mailto:lexing@globalmarket.com)  
[www.lexing.com.cn](http://www.lexing.com.cn)  
[www.lexing.com](http://www.lexing.com)