

LEXiNG®

Light Control Switch Instruction

LX-P01 ☐



IP 44

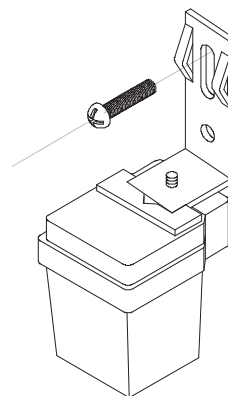
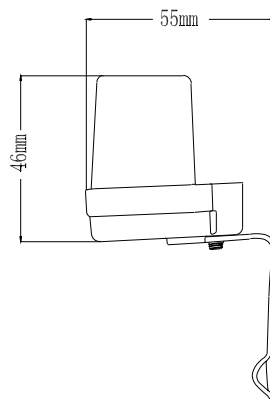
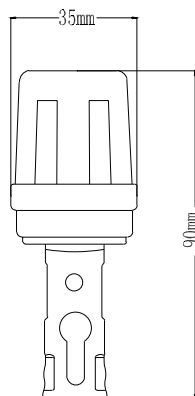

LXP-02 ☐



IP 54

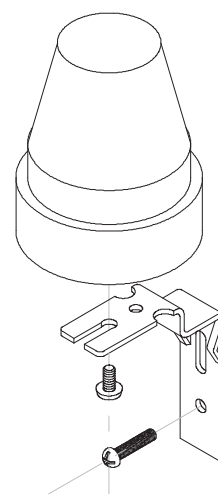
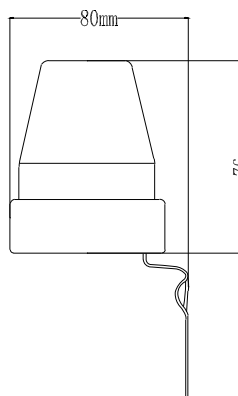
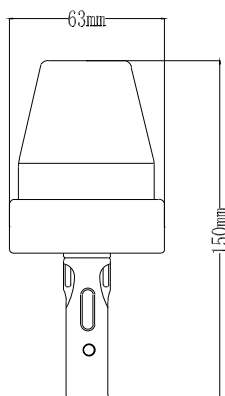

LX-P03 ☐



IP 54

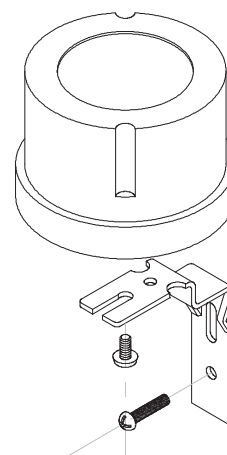
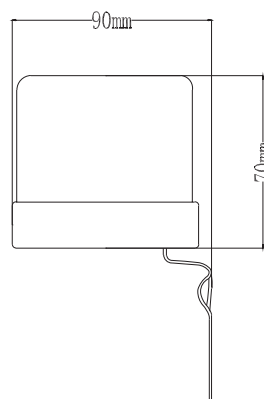
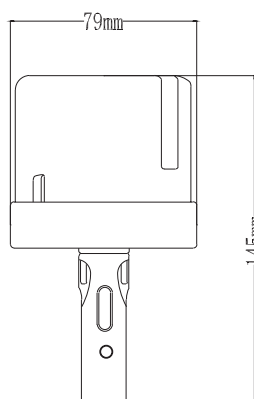

Summary

The product can turn on or turn off light according to ambient-light; Ambient-temperature and humidity can't affect it. It is not only convenient but also practical, it can control the load working only at night. For instance road light, garden light etc.

Specifications

Power Source: 220-240V/AC <input type="checkbox"/>	Rated Current: 6A <input type="checkbox"/>
100-130V/AC <input type="checkbox"/>	10A <input type="checkbox"/>
Power frequently: 50/60Hz	15A (only LX-P03) <input type="checkbox"/>
Light-control: 8~30LUX(LX-P01)	25A (only LX-P03) <input type="checkbox"/>
<5~100LUX (only LX-P02 LX-P03)	

Notice

1. In front of the light control switch there should be no obstruction affecting it to accept natural light;
2. In front of the light control switch there should be no swaying object.

Test

- 1、Please use the black poke in packing or opaque when testing in the daytime.
- 2、When use this black poke, it makes lamp on.
- 3、When take off this black poke, it makes lamp off.
- 4、Take off this black poke after testing.

Connection-wire diagram

BLACK(BROWN): L

GREEN(BLUE): N

RED : LOAD

